



Anti-vibration table for balances and APP series comparators.  
A low steel construction with a massive granite plate placed directly on the construction.

For work with the comparator there is an additional draft shield masking the whole table construction.

- Two different table variants available:
- SA/APP/C – powder coated steel design;
  - SA/APP/H – stainless steel design.

SA/APP laboratory table comprises the following components:

- Top (granite slab)
- Base (stainless steel or powder coated design)
- Dampeners
- Adjustable feet

## Dimensions:

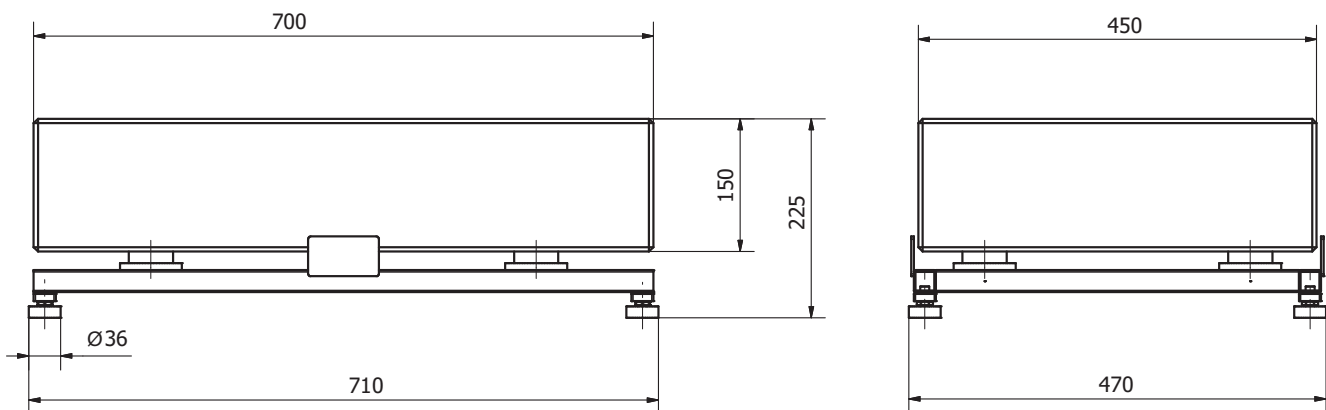

## Technical specification:

Labolatory table:	SA/APP/C	SA/APP/H
Length	700 mm	700 mm
Width	450 mm	450 mm
Height	225 mm	225 mm
Table top thickness	150 mm	150 mm
Table top weight	~155 kg	~155 kg
Total mass of the table	~180 kg	~180 kg
Materials	polished granite / mild steel	polished granite / stainless steel